

HOUR

MEDIA

how-to

Convert to Profile in Adobe Photoshop

Screen captures are shown in Mac OS X; however, instructions are universal between Windows and Mac.

1. In the top toolbar, navigate to "Edit" and choose "Convert To Profile."
2. In the new dialog box that appears, choose the following settings to conform to Hour Media/SWOP color standards:

Destination Space:

SWOP2006_Coated3v2.icc

Conversion Options:

Engine: Adobe (ACE)

Intent: Relative Colorimetric

"Use Black Point Compensation" and "Use Dither" should be checked on.

For instructions on how to install the SWOP2006_Coated3v2.icc, see below.

3. Save image. Make sure the option to "Embed Color Profile" is NOT checked.

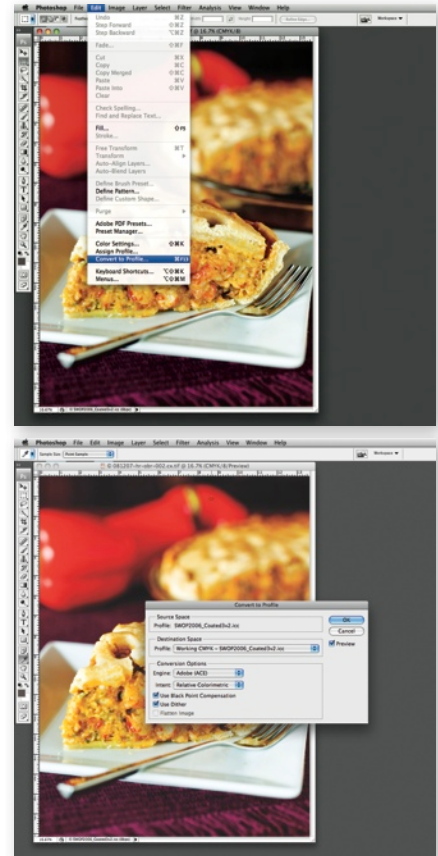

how-to

Install ICC profiles

In order to convert to the SWOP2006_Coated3v2.icc profile it must first be installed in the system. The profile is available free for download at:

www.gracol.com/resources/ICC2006.zip

Install for Windows XP & Vista:

In your hard drive, navigate to: **Windows > system32 > spool > drivers > color** and copy the "SWOP2006_Coated3v2.icc" file here. Alternately, you may be able to right-click on the profile in Windows Explorer and select "install profile."

Install for Windows NT & 2000:

In your hard drive, navigate to: **Winnt > system32 > spool > drivers > color** and copy the "SWOP2006_Coated3v2.icc" file here. Alternately, you may be able to right-click on the profile in Windows Explorer and select "install profile."

Install for Mac OS X:

In your hard drive, navigate to: **Library > ColorSync > Profiles** and copy the "SWOP2006_Coated3v2.icc" here.

Beyond these directions, we cannot offer technical support.